



**FORNITURE  
INDUSTRIALI**

# QUICK COUPLINGS

NOTE: STAINLESS STEEL, ALUMINUM ALLOY, BRONZE,  
ALL COUPLINGS COME WITH STAINLESS STEEL  
CAMS, RINGS WILL NOT RUST OR BEND, FOR  
GREATER STRENGTH AND SAFETY.

## TYPE A ADAPTER

- Female thread—Tapered pipe thread (PT nr NPT)
- Designed to be serviceable for pipe with male thread or nipple with male thread for hose.
- Please use dust cap in order to prevent abrasion and provide all inside surface with complete protection from dust, dirt or other foreign matter.

- Aluminum Alloy
- Bronze
- Stainless Steel

SIZES	inches	1/2	3/4	1	1 1/4	1 1/2	2	2 1/2	3	4	5	6
	mm	15	20	25	32	40	50	65	80	100	125	150
D		32	32	37	45	53	63	76	92	120	146	176
E		14	19	24	29	37	46	55	73	98	122	148
K		32	38	41	51	57	71	84	100	129	168	192
h		26	26	32	41	42	48	50	50	53	55	60
H		41	41	49	54	55	64	70	70	80	79	86

(Unit mm)

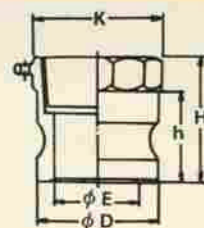

## TYPE B COUPLER

- Male thread—Tapered pipe thread (PT or NPT)
- Designed to serviceable for pipe with female thread (part of socket).

- Aluminum Alloy
- Bronze
- Stainless Steel

SIZES	inches	1/2	3/4	1	1 1/4	1 1/2	2	2 1/2	3	4	5	6
	mm	15	20	25	32	40	50	65	80	100	125	150
A		116	116	125	177	188	197	210	248	280	306	595
B		50	50	60	80	89	97	110	135	165	190	254
C		32	32	37	46	53	63	76	92	120	146	176
F		16	22	26	35	38	50	61	75	94	117	142
h		33	33	40	49	48	52	57	60	60	65	70
H		52	52	62	67	70	79	89	91	102	105	115

(Unit mm)

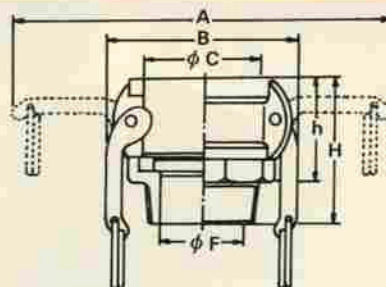

# QUICK COUPLINGS

NOTE: STAINLESS STEEL, ALUMINUM ALLOY, BRONZE,  
ALL COUPLINGS COME WITH STAINLESS STEEL  
CAMES, RINGS WILL NOT RUST OR BEND, FOR  
GREATER STRENGTH AND SAFETY.

## TYPE C HOSE SHANK COUPLER

- This is designed with "hank ends" which can be attached directly to uncoupled rubber hose or vinyl chloride hose with any type clamp\* or bands.

- Aluminum Alloy
- Bronze
- Stainless Steel

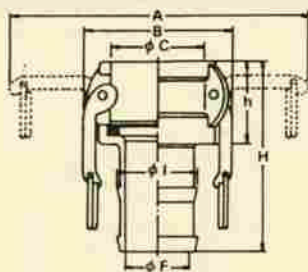

SIZES	inches	1/2	3/4	1	1 1/4	1 1/2	2	2 1/2	3	4	5	6
	mm	15	20	25	32	40	50	65	80	100	125	150
A	—	116	125	177	188	197	210	248	280	306	595	
B	—	50	60	80	89	97	110	135	165	190	254	
C	—	32	37	46	53	63	76	92	120	146	176	
F	—	14	20	25	32	45	57	67	89	114	142	
h	—	21	27	34	41	53	67	79	105	134	157	
H	—	33	40	49	48	55	57	59	62	65	70	
H	—	84	98	103	106	127	137	160	170	189	214	

(Unit mm)

## TYPE D COUPLER

- Female thread—Tapered pipe thread (PT or NPT)
- Designed to be serviceable for pipe with male thread or nipple with male thread for flexible metal hose or rubber hose.

- Aluminum Alloy
- Bronze
- Stainless Steel

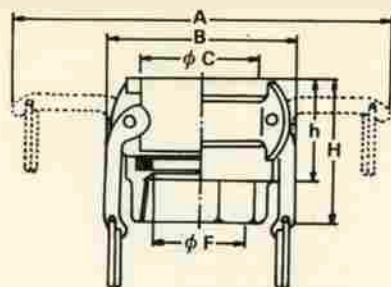

SIZES	inches	1/2	3/4	1	1 1/4	1 1/2	2	2 1/2	3	4	5	6
	mm	15	20	25	32	40	50	65	80	100	125	150
A	116	116	125	177	188	197	210	248	280	306	595	
B	50	50	60	80	89	97	110	135	165	190	254	
C	32	32	37	46	53	63	76	92	120	146	176	
F	16	22	26	35	38	50	61	75	94	117	142	
h	32	32	42	50	51	55	56	61	62	65	70	
H	51	51	62	71	71	75	86	89	95	100	115	

(Unit mm)





**FORNITURE INDUSTRIALI**

# QUICK COUPLINGS

NOTE: STAINLESS STEEL, ALUMINUM ALLOY, BRONZE,  
ALL COUPLINGS COME WITH STAINLESS STEEL  
CAMB. RINGS WILL NOT RUST OR BEND, FOR  
GREATER STRENGTH AND SAFETY.

## TYPE E HOSE SHANK ADAPTER

- This is designed with shank ends which can be attached directly to uncoupled rubber hose or vinyl chloride hose with any type clamps or bands.
- Please use dust cap in order to prevent abrasion and provide all inside surface with complete protection from dust, dirt or other for foreign matter.

- Aluminum Alloy
- Bronze
- Stainless Steel

SIZES	inches	1/2	3/4	1	1 1/4	1 1/2	2	2 1/2	3	4	5	6
	mm	15	20	25	32	40	50	65	80	100	125	150
D	—	32	37	45	53	63	76	92	120	146	176	
E	—	19	24	29	37	46	55	73	98	122	148	
F	—	14	20	25	31	43	55	67	92	117	142	
I	—	21	27	34	40	53	67	79	105	134	158	
J	—	33	39	48	56	66	80	102	133	158	183	
h	—	41	47	55	57	60	67	67	70	73	78	
H	—	92	106	113	117	130	146	168	178	200	220	

(Unit mm)

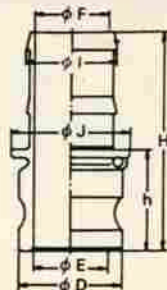

## TYPE F ADAPTER

- Male thread—Tapered pipe thread (PT or NPT)
- Designed to be serviceable for pipe with female thread (part of socket socket)
- Please use dust cap in order to prevent abrasion and provide all inside surface with complete protection from dust, dirt or other for foreign matter.

- Aluminum Alloy
- Bronze
- Stainless Steel

SIZES	inches	1/2	3/4	1	1 1/4	1 1/2	2	2 1/2	3	4	5	6
	mm	15	20	25	32	40	50	65	80	100	125	150
D		32	32	37	45	53	63	76	92	120	146	186
E		14	10	24	29	37	46	55	73	98	122	148
K		32	38	41	51	57	71	84	100	129	168	192
h		26	26	32	41	42	48	50	50	53	55	60
H		55	55	65	76	79	86	97	100	114	117	129

(Unit mm)

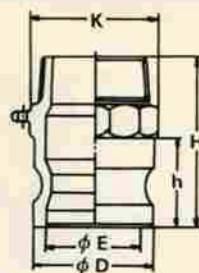



**FORNITURE  
INDUSTRIALI**

# QUICK COUPLINGS

NOTE: STAINLESS STEEL, ALUMINUM ALLOY, BRONZE,  
ALL COUPLINGS COME WITH STAINLESS STEEL  
CAMS, RINGS WILL NOT RUST OR BEND, FOR  
GREATER STRENGTH AND SAFETY.

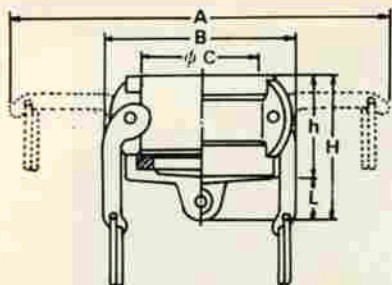

## TYPE *DC* (G) DUST CAP

● Designed for adapters type "A, F, E"

- Aluminum Alloy
- Bronze
- Stainless Steel

SIZES	inches	1/2	3/4	1	1 1/4	1 1/2	2	2 1/2	3	4	5	6
	mm	15	20	25	32	40	50	65	80	100	125	150
A	—	116	125	177	188	197	210	248	280	306	595	
B	—	50	60	80	89	97	110	135	165	190	254	
C	—	32	37	46	53	63	76	92	120	146	176	
L	—	13	15	16	18	18	20	20	20	20	20	
h	—	32	41	51	51	57	60	60	62	65	70	
H	—	45	56	67	69	75	80	80	82	85	90	

(Unit: mm)

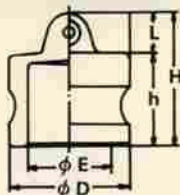

## TYPE *DP* (H) DUST PLUG

● Designed for couplers Type "D, C, B"

- Aluminum Alloy
- Bronze
- Stainless Steel

SIZES	inches	1/2	3/4	1	1 1/4	1 1/2	2	2 1/2	3	4	5	6
	mm	15	20	25	32	40	50	65	80	100	125	150
D	—	32	37	45	53	63	76	92	120	146	176	
E	—	19	24	29	37	46	55	73	98	122	148	
L	—	13	15	16	18	20	20	20	20	25	25	
h	—	27	33	42	43	49	51	51	54	54	60	
H	—	40	48	58	61	69	71	74	79	79	85	

(Unit: mm)